

# maxell® UR 46

POSITION:IEC TYPE I · NORMAL

UR  
46

maxell

**A** DATE \_\_\_\_\_ . \_\_\_\_\_ . \_\_\_\_\_  
N.R.  YES  NO

**B** DATE \_\_\_\_\_ . \_\_\_\_\_ . \_\_\_\_\_  
N.R.  YES  NO

**A**

**B**

# maxell UR 46

POSITION-IEC TYPE I · NORMAL

# maxell UR 46

POSITION  
IEC TYPE I  
NORMAL

TAPE SELECTOR	BIAS	EQ	RECORDING TIME
NORMAL (IEC TYPE I)	NORMAL	120 $\mu$ s	46min. (2 x 23)

• **Dynamic rendition of live music.**

Maxell's New-PX (pure crystal) gamma-ferric oxide particles have improved the output level by 1 dB in the low-frequency range and by 2 dB in the high-frequency range. Noise has been further reduced by 0.5 dB. (Compared with our LN tape)

• **Easy-to-use, extra-high precision cassette design.**

Tape end can be easily judged through the widened window. Replaceable title labels are convenient for clearly showing contents of the recorded material.

The finest precision-engineered cassette mechanism assures the smoothest, most consistent tape travel.



**MAXELL FULL WARRANTY** We warrant to the user of this product that it is free from defective materials and workmanship. If the product proves unsatisfactory, it will be replaced if returned to Maxell America, Inc., 1400 Parker Road, Conyers, Georgia 30207. *Manufacturer, distributor and seller shall not be liable for consequential commercial damages.*

MAXELL CORPORATION OF AMERICA  
22-08 ROUTE 208, FAIR LAWN, NJ 07410

JAPAN COMPONENTS (Assembled in R. Korea)

## Maxell Cassette Tape Features

In the cassette Maxell adapts the unique 4-function leader to incorporate the cleaning properties of its original head cleaning tape. The special finish assures continuous cleaning without fear of head wear.

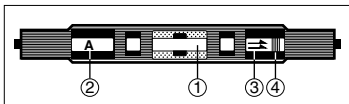

- ① Non-abrasive head cleaning leader tape.
- ② Indicates A or B side ready to play.
- ③ Arrows indicate direction of tape travel.
- ④ 5-second cueing line.

## Handling/Storage Instructions

- To prevent the tape from developing trouble in travel, take up any slack in the cassette by using a pencil stub as shown in the illustration.
- Break off the breakout lugs from the cassette to prevent the recorded material from accidental erasing.
- To assure smooth tape travel and high quality recording/playback, periodical cleaning of the heads and capstans is recommended.
- Store the cassettes in their plastic bases after use. During storage, keep them from heat, humidity, magnetic fields and dust.

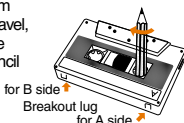

Maxell Corporation of America  
PROOF OF PURCHASE

maxell  
UR 46